

FIRST IN 1882



LEADING EVER SINCE

Safety

Satisfaction

# THE ORIGINAL AND GENUINE SIEVERT GASOLINE AND KEROSENE BLOW TORCHES

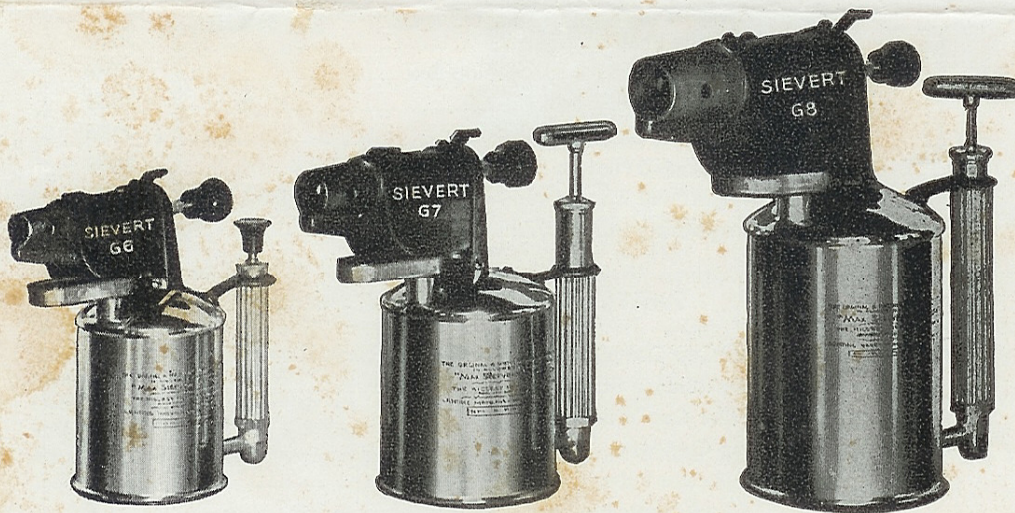

Recommended to:

UTILITY COMPANIES  
RAILROADS  
TELEPHONE  
COMPANIES  
ELECTRICIANS  
PLUMBERS &  
STEAMFITTERS  
ELEVATOR  
COMPANIES  
PAINTERS  
ETC.

For

BRAZING  
SOLDERING  
BENDING  
EXPANDING  
BURNING PAINT  
COPPER TUBING  
THAWING

Sievert torches are acknowledged the World's Best, and for over 50 years of manufacturing their one and only goal has been quality. After a very thorough test by our mechanical engineer our conclusion is "It is the peer of them all."

Tank is constructed of heavy, non-porous brass, double-gauge bottom that is lapped and brazed — no soldering whatsoever — and will withstand an inner pressure of 110 pounds. Patented safety valve in filler cap automatically releases excess pressure. ABSOLUTELY EXPLOSION-PROOF.

Special cast alloy burner (Sievert Secret) that will not burn off at the tip. Straight channel gasifier, without gauze, easy to clean.

Regulating valve with cleaning needle removes carbon in the orifice without enlarging it. Valve control produces two types of flame; one a sharp pointed flame for fine soldering, and the other a strong, intense blast for heavy soldering and brazing. TWO TORCHES IN ONE.

Will function in any weather and under all conditions. **BURNS IN ANY POSITION.**

SIEVERT	# G-6	# G-7	# G-8
Capacity of Container	¾ Qt.	1 Qt.	2 Qt.
Length of Flame	8 in.	12 in.	15 in.
Diameter of Flame Tube	¾ in.	1 in.	1½ in.
Melts Copper Wire ⅜" x 2"	70 sec.	60 sec.	40 sec.
Burns at Full Flame	60 min.	45 min.	45 min.
Weight (Empty)	3 lbs.	4 lbs.	7 lbs.
<b>PRICE</b>	<b>\$9.50</b>	<b>\$12.00</b>	<b>\$18.00</b>

**J. A. SANDERS**  
DISTRIBUTOR

P. O. BOX 123

FULTON, N. Y.

**SPARE PARTS FOR #E9 "SIEVERT" FURNACES**

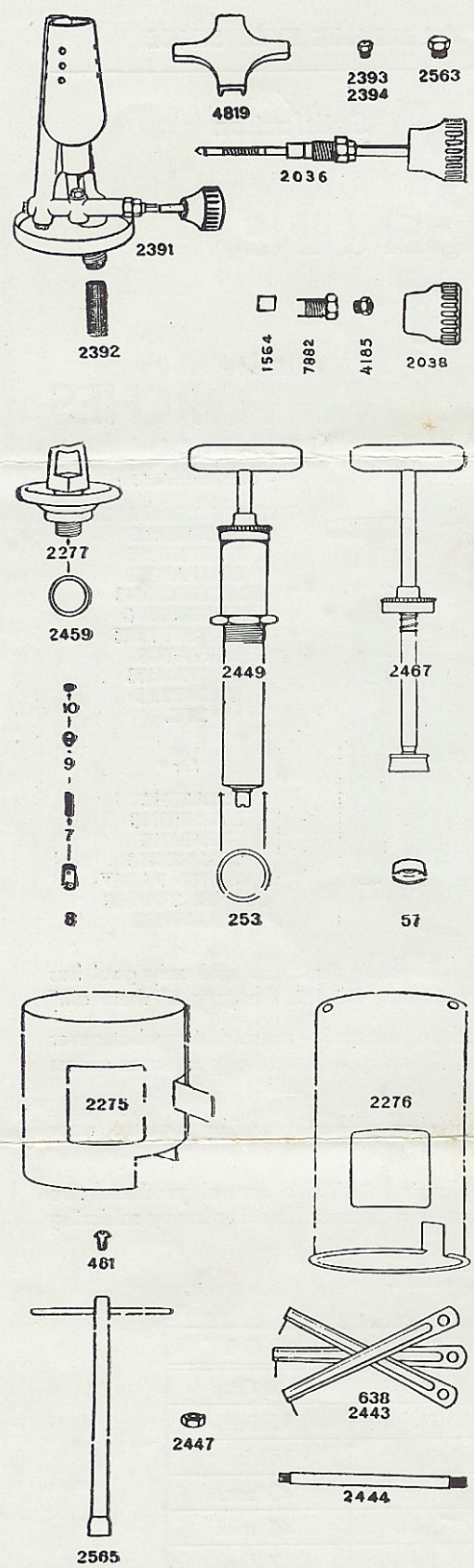

**NOTE:**  
For maximum service and satisfaction it is absolutely essential to use only genuine "SIEVERT" replacement parts

DESCRIPTION	Part No.	Price
<b>PARTS FOR BURNER</b>		
Burner Complete, Gasoline.....	2391	\$7.00
Burner Complete, Kerosene.....	2390	7.00
Nozzle, Gasoline.....	2394	.30
Nozzle, Kerosene.....	2393	.30
Nozzle Key.....	2565	.50
Cleaning Needle, Gasoline.....	638	.15
Cleaning Needle, Kerosene.....	2443	.15
Plug Screw.....	2563	.10
Wire Gauze.....	2392	.25
Pre-Heating Pan.....	2400	.50
Regulating Spindle Complete.....	2035	1.00
Spindle Shaft.....	2037	.35
Asbestos Packing for Stuffing Box.....	1564	.10
Nut for Stuffing Box.....	7882	.20
Screw for Stuffing Box.....	4185	.10
Regulating Handle.....	2038	.20
Regulating Handle Washer.....	2039	.05
Regulating Handle Nut.....	4959	.05
<b>PARTS FOR TANK AND PUMP</b>		
Filler Cap Complete with Air Release Screw.....	2277	.75
Air Release Screw.....	2278	.15
Filler Cap Washer.....	2459	.05
Pump Complete.....	2449	3.50
Asbestos Pump Cylinder Washer.....	253	.05
Check Valve Housing.....	8	.25
Check Valve Spring.....	7	.10
Check Valve Seat.....	9	.10
Check Valve Rubber Washer.....	10	.05
Pump Plunger Complete.....	2467	1.25
Pump Cap.....	685	.20
Plunger Spring.....	2373	.10
Leather Cup Washer.....	57	.10
Plunger Nut.....	58	.05
Upright Standard.....	2444	.25
Upright Standard Nut.....	2447	.05
Top Casting and Handle.....	4820	2.00
Flame Spreader for Top Casting.....	4819	.25
Stationary Windshield.....	2276	1.25
Sliding Windshield.....	2275	1.25
Screw for Windshield.....	461	.05
Tank.....		5.00
"C" Hood for holding Solder Pot (Diameter 7 1/2").....		1.00
"B" Hood for Heating Soldering Irons.....		2.50
7" Solder Pot (Cast Iron).....		1.50

Sievert  
The Pioneer of  
Blowlamps



First in 1882  
leading  
ever since

## SOLDERING AND MELTING FURNACES

For  
GASOLINE  
and  
KEROSENE



WINDPROOF  
STORMPROOF

### TYPE E-9 (Capacity 1 Gallon)

For Melting: **LEAD, BABBITT, TIN, PARAFFIN, TAR**

For Heating: **SOLDERING IRONS, BRANDING IRONS, RIVETS, etc.**

For Bending: **PIPE, etc.**

In actual tests the SIEVERT Fire Pot proved far superior in quality and performance to all other similar equipment. (Melts 25 pounds of solder, ready for use, in 10 minutes).

Container of double pickled sheet steel, perfectly welded. Large funnel, and air release filler cap.

Burners of bronze composition, fitted with valve to control flame. STRAIGHT CHANNEL TYPE: NO COILS: EASY TO CLEAN.

Powerful heavy gauge brass pump to insure steady, even flame.

Handle on top plate serves as support for soldering irons.

Suitable for indoor and outdoor use.

Apparatus can be converted from gasoline to kerosene, or vice versa, by simply replacing the orifice.

Price with "C" or "B" Hood, \$20.00.

Every apparatus is tested and guaranteed to give long service under the most severe working conditions.

PRICE \$18.50

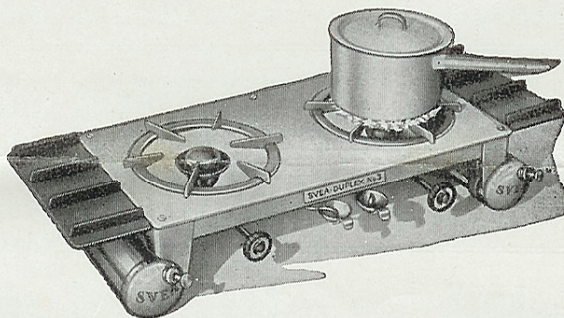

## SIEVERT Paraffin Ranges (Kerosene)

### "Svea-Duplex No. 3" two burners

are equipped with

SIEVERT Svea-burner No. 1815, with knob permitting fine flame regulation or complete shut-off, also self-cleaning the nipple when valve is closed.

SIEVERT patented "measuring cup" which, when filling with spirit, automatically feeds the lighting cup with the amount of spirit required for preheating.

The range may be extended by a loose side-piece (No. 10580) nickelplated in matt finish, supplied on request.

Made either in attractive green or cream enamel, or nickel-plated.

**J. A. SANDERS**  
DISTRIBUTOR

P. O. BOX 123

FULTON, N. Y.

# SPARE PARTS for GENUINE "SIEVERT" BLOW TORCHES

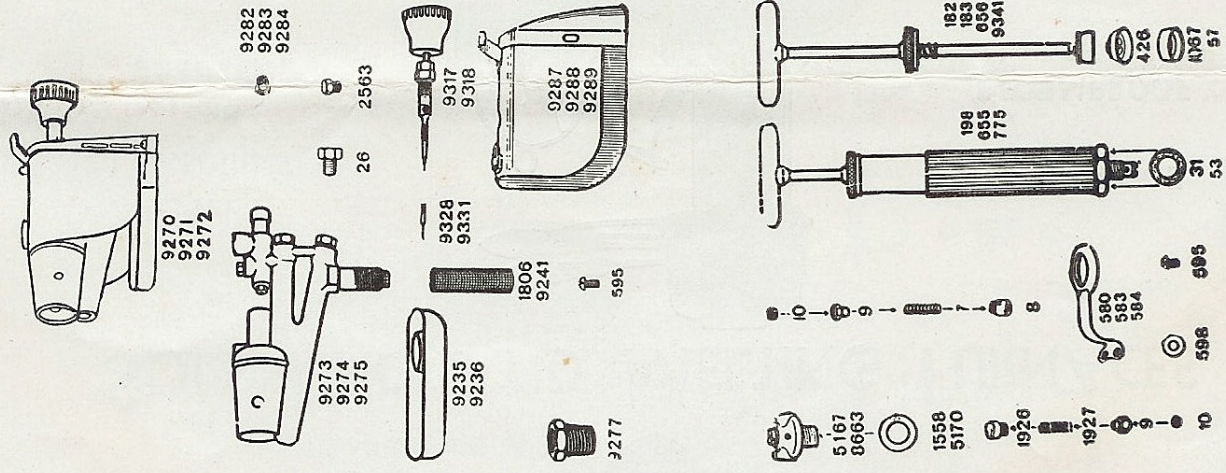

We pride ourselves on being in a position to render 100% Service at all times.

TYPE DESCRIPTION	No. G-6		No. G-7		No. G-8	
	Part No.	Price	Part No.	Price	Part No.	Price
<b>PARTS FOR BURNER</b>						
Burner Complete.....	9270	\$4.50	9271	\$6.00	9272	\$9.00
Nozzle, Gasoline.....	9282	.25	9283	.25	9284	.25
Nozzle, Kerosene.....	9281	.25	9282	.25	9283	.25
Nozzle Key.....	2565	.50	2565	.50	2461	.50
Top Plug Screw.....	2563	.10	2563	.10	2563	.10
Rear Plug Screw.....	2563	.10	26	.15	26	.15
Wire Gauze.....	9241	.25	9241	.25	1806	.25
Pre-Heating Pan.....	9235	.30	9235	.30	9236	.45
Windshield with Soldering Attachments.....	9287	.50	9288	.50	9289	.75
Screw for Windshield.....	596	.05	596	.05	596	.05
Regulating Spindle Complete.....	9317	1.00	9317	1.00	9318	1.00
Spindle Shaft with Pin.....	9319	.35	9319	.35	9320	.35
Cleaning Pin, Gasoline.....	9328	.10	9328	.10	9331	.10
Cleaning Pin, Kerosene.....	9327	.10	9328	.10	9328	.10
Asbestos Packing for Stuffing Box.....	1564	.10	1564	.10	1564	.10
Nut for Stuffing Box.....	7882	.20	7882	.20	7882	.20
Screw for Stuffing Box.....	4185	.10	4185	.10	4185	.10
Regulating Handle.....	2038	.20	2038	.20	2038	.20
Regulating Handle Washer.....	2039	.05	2039	.05	2039	.05
Regulating Handle Nut.....	4959	.05	4959	.05	4959	.05
<b>PARTS FOR TANK AND PUMP</b>						
Threaded Union Nut to adapt No. 9270 and No. 9271 Burner to No. G-8 2-Qt. Tank.....	.....	.....	.....	.....	9277	.50
Filler Cap Complete.....	8663	.35	8663	.35	5167	.50
Filler Cap Washer.....	1558	.05	1558	.05	5170	.05
Top Screw for Safety Valve.....	1926	.10	1926	.10	1926	.10
Spring for Safety Valve.....	1927	.10	1927	.10	1927	.10
Seat for Safety Valve.....	9	.10	9	.10	9	.10
Packing for Safety Valve.....	10	.05	10	.05	10	.05
Pump Complete.....	42	2.00	655	3.00	775	3.00
Pump Cylinder w/o Check Valve.....	43	1.00	657	1.50	776	1.75
Asbestos Pump Cylinder Washer.....	31	.05	31	.05	31	.05
Check Valve Housing.....	8	.25	8	.25	8	.25
Check Valve Spring.....	7	.10	7	.10	7	.10
Check Valve Seat.....	9	.10	9	.10	9	.10
Check Valve Rubber Washer.....	10	.05	10	.05	10	.05
Pump Plunger Complete.....	183	.90	656	1.00	9341	1.25
Bakelite Pump Knob.....	752	.20	.....	.....	.....	.....
Pump Cap.....	40	.20	690	.20	690	.20
Leather Cup Washer.....	.....	.....	1067	.10	1067	.10
Leather Cup Washer Assembly.....	426	.20	.....	.....	.....	.....
Plunger Spring.....	1068	.10	1068	.10	1068	.10
Plunger Nut.....	1066	.05	1066	.05	1066	.05
Pump Bracket.....	580	.25	583	.25	583	.25
Screw for Pump Bracket.....	595	.05	595	.05	595	.05
Washer for Pump Bracket.....	598	.05	598	.05	598	.05
Container, Brass.....	1 1/2 Pt.	2.25	.....	.....	2-Qt.	5.00