

Your "Better Service" Bond

This Coleman appliance was made by skilled workmen using only fine quality materials. It is a product which you may well be proud to own and we know you will want to exercise the little care necessary so it may serve you long and well.

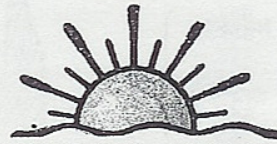

TRADE MARK REGISTERED

Coleman

MADE IN CANADA

DIRECTIONS

BLOW TORCHES

GASOLINE MODELS 91, 92, 101, 102, 151, 152,
201, 202, 251—KEROSENE MODELS 203, 204, 252



The Coleman Lamp and Stove Company Ltd
Toronto Canada

DIRECTIONS FOR THE OPERATION OF COLEMAN BLOW TORCHES

1. TO FILL: Make sure regulating valve stem is closed tightly to the right. Remove filler plug in bottom of tank. (Note—on models 91 and 92 remove pump) and fill nearly full with fresh, clean, untreated gasoline. (Use kerosene in Models 203, 204, 252 only.) Replace filler plug and tighten (gently).

FUEL

GASOLINE — Never use ethyl or lead treated gasoline in any blow torch. Some coloured gasolines are of good quality and do not contain any lead. It is the lead in gasoline and the quality of the gasoline, not the dye, that affect its use in appliances. High test gasoline such as "Lighting Naphtha" is excellent for gasoline blow torches.

KEROSENE — Use kerosene (coal oil) in Nos. 203, 204, 252 Kerosene Torches only. Note—These models will also burn gasoline.

2. TO PUMP: Pump air into fount until a reasonable pressure resistance is noticed.

3. TO LIGHT: Pour alcohol (methylated spirits) into pre-heater cup until about $\frac{3}{4}$ full. When alcohol is not available, hold palm of hand against front opening of burner, open regulating valve slightly and let fuel flow slowly into pre-heater cup. Close valve before cup overflows. If any alcohol or fuel spills on fount, wipe it off carefully before lighting cup. Light fuel in preheater cup—wait until flame has

nearly consumed all the fuel, then open regulating valve and the burner will light. Depending on pressure in fount or weather conditions it might be necessary to hold a burning match close to the air holes; never in front of burner. Good preheating is essential, especially in cold or windy weather. It may be necessary to preheat twice, especially when fuel from the fount is used for preheating. Always shelter torch from draughts while preheating. Avoid too much pressure at the start. After torch has been burning about a minute you may increase the pressure in order to increase flame volume. Use regulating valve for regulating flame.

NOTE—Use kerosene (coal oil) in Models No. 203, 204, 252 only. All other models use gasoline.

4. TO TURN OUT: Turn regulating valve stem to the right until tight; do it gently.

USEFUL SUGGESTIONS

- Keep pump leather well oiled.
- Examine cork in pump check valve if pump leaks.
- If leak develops at valve stem, tighten pack-nut when torch is not burning.
- If burner fails to light, release pressure from fount by opening and closing filler plug. Remove valve stem and clean needle and gas tip.
- Clean out fount occasionally. Empty the fount and rinse with fresh, clean fuel.
- Always use genuine Coleman replacement parts.



Model
No. 92 (Quart)



Models
No. 91 (Pint)
No. 101 (Pint)
No. 102 (Quart)



Models
No. 151 (Pint)
No. 152 (Quart)



Models
No. 201 (Pint)
No. 202 (Quart)
No. 203 (Pint)
No. 204 (Quart)
No. 251 (2 Quart)
No. 252 (2 Quart)

Coleman

MADE IN
CANADA

Blow

PARTS LIST FOR ALL MODELS

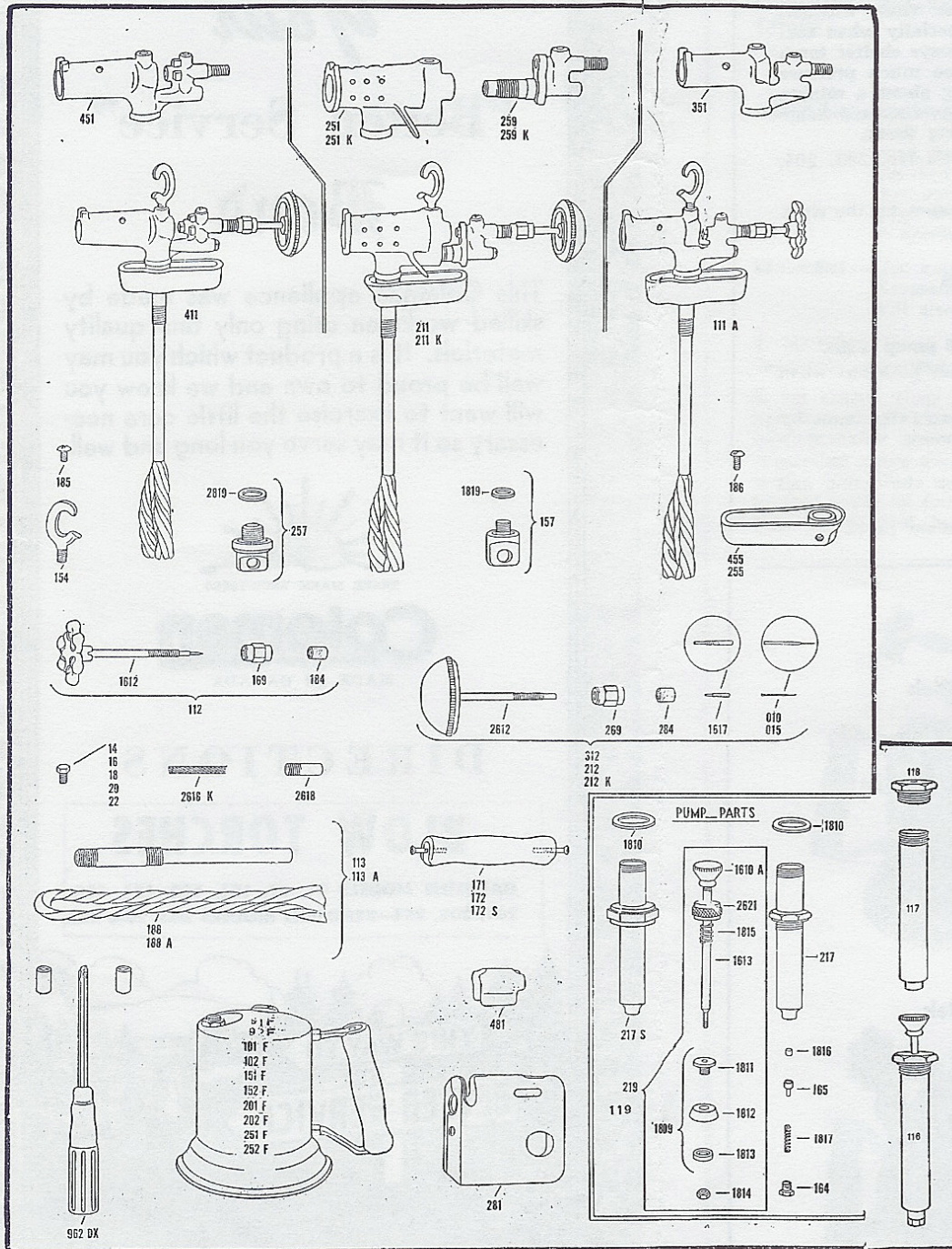

| Part No. | DESCRIPTION |
|----------|-------------------------|
| 010 | Needle |
| 015 | Needle |
| 14 | Gas Tip |
| 16 | Gas Tip |
| 18 | Gas Tip |
| 20 | Gas Tip |
| 22 | Gas Tip |
| 91F | Fount (Pint) |
| 92F | Fount (Quart) |
| 101F | Fount (Pint) |
| 102F | Fount (Quart) |
| 111A | Burner complete |
| 112 | Valve stem complete |
| 113 | Feed tube complete |
| 113A | Feed tube complete |
| 116 | Pump complete |
| 117 | Pump Barrel |
| 118 | Pump Cap |
| 119 | Pump Plunger complete |
| 161F | Fount (Pint) |
| 162F | Fount (Quart) |
| 154 | Soldering Iron Hook |
| 157 | Filler Plug with lead v |
| 164 | Pump check valve nozz |
| 165 | Check valve plunger (l |
| 169 | Valve stem packing nut |
| 171 | Wooden handle with se |
| 172 | Wooden handle with se |
| 172S | Wooden handle with se |
| 184 | Valve stem packing |
| 185 | Burner screw |
| 186 | Preheater cup screw |
| 188 | Feed wick only |
| 188A | Feed wick only |
| 201F | Fount (Pint) |
| 202F | Fount (Quart) |
| 211 | Burner complete |
| 211K | Burner complete |
| 212 | Valve stem complete |
| 212K | Valve stem complete |
| 216 | Pump complete |
| 216S | Pump complete |
| 217 | Pump barrel |
| 217S | Pump barrel |
| 219 | Pump plunger complete |
| 251 | Burner body (front) |
| 251F | Fount (Two Quart) |
| 251K | Burner body (front) |
| 252F | Fount (Two Quart) |
| 255 | Preheater cup |
| 257 | Filler plug |
| 259 | Burner body (back) |
| 259K | Burner body (back) |
| 269 | Valve stem pack nut |
| 281 | Windshield |
| 284 | Valve stem packing |
| 312 | Valve stem complete |
| 351 | Burner body (one piec |
| 411 | Burner complete |
| 451 | Burner body (one piec |
| 455 | Preheater cup |
| 481 | Windshield |
| *962DX | Gas tip wrench |
| 1610A | Pump handle |
| 1612 | Valve stem (cast iron |
| 1613 | Pump rod |
| 1617 | Needle bushing |
| 1809 | Pump piston complete |
| 1810 | Pump bushing lead wa |
| 1811 | Pump piston |
| 1812 | Pump leather |
| 1813 | Pump piston nut |
| 1814 | Pump rod nut |
| 1815 | Pump rod cushion spr |
| 1816 | Pump check valve cork |
| 1817 | Pump check valve spri |
| 1819 | Lead washer for filler |
| 2612 | Valve stem (bakelite w |
| 2618 | Vaporizer tube |
| 2618K | Vaporizer filler |
| 2621 | Pump cap |
| 2819 | Lead washer for filler |

ALWAYS USE GENUINE COLEMAN SPARE PARTS

SPECIFY FOUNT CAPACITY WHEN ORDERING PARTS FOR A TORCH

* Packed and sold separately.

MADE IN
CANADA

Blow-Torches

LIST FOR ALL MODELS

| Part No. | DESCRIPTION | USED ON MODELS | | |
|----------|---------------------------------|--------------------|--------------------|---------------|
| | | Pint Sizes | Quart Sizes | 2 Quart Sizes |
| 010 | Needle | 151, 203 | 204 | |
| 015 | Needle | 201 | 152, 202 | 251, 252 |
| 14 | Gas Tip | 203 | 204 | |
| 16 | Gas Tip | 91, 101, 151 | 92, 102 | 253 |
| 18 | Gas Tip | 201 | 152 | |
| 20 | Gas Tip | | 202 | |
| 22 | Gas Tip | | | 251 |
| 91F | Fount (Pint) | 91 | 92 | |
| 92F | Fount (Quart) | | | |
| 101F | Fount (Pint) | 101 | | |
| 102F | Fount (Quart) | | 102 | |
| 111A | Burner complete | 91, 101 | 92, 102 | |
| 112 | Valve stem complete | 91, 101 | 92, 102 | |
| 113 | Feed tube complete | | All Models | 251, 252 |
| 113A | Feed tube complete | All Models | | |
| 116 | Pump complete | | 92 | |
| 117 | Pump Barrel | | 92 | |
| 118 | Pump Cap | | 92 | |
| 119 | Pump Plunger complete | | 92 | |
| 151F | Fount (Pint) | 151 | | |
| 152F | Fount (Quart) | | 152 | |
| 154 | Soldering Iron Hook | All Models | All Models | 251, 252 |
| 157 | Filler Plug with lead washer | 101, 151, 201, 203 | 102, 152 | |
| 164 | Pump check valve nozzle | All Models | All Models | 251, 252 |
| 165 | Check valve plunger (less cork) | " " | " " | " " |
| 169 | Valve stem packing nut | 91, 101, 151 | 92, 102, 152 | |
| 171 | Wooden handle with screws | 91, 101 | 92, 102 | |
| 172 | Wooden handle with screws | 151, 201, 203 | 152, 202, 204 | 251, 252 |
| 172S | Wooden handle with screws | | | |
| 184 | Valve stem packing | 91, 101, 151 | 92, 102, 152 | |
| 185 | Burner screw | All Models | All Models | 251, 252 |
| 186 | Preheater cup screw | " " | " " | " " |
| 188 | Feed wick only | | All Models | " " |
| 188A | Feed wick only | All Models | | |
| 201F | Fount (Pint) | 201, 203 | | |
| 202F | Fount (Quart) | | 202, 204 | |
| 211 | Burner complete | 201 | 202 | 251 |
| 211K | Burner complete | 203 | 204 | 253 |
| 212 | Valve stem complete | 201 | 202 | 251 |
| 212K | Valve stem complete | 203 | 204 | 253 |
| 216 | Pump complete | All Models | 102, 152, 202, 204 | 251, 252 |
| 216S | Pump complete | | | |
| 217 | Pump barrel | All Models | 102, 152, 202, 204 | 251, 252 |
| 217S | Pump barrel | | | |
| 219 | Pump plunger complete | All Models | 102, 152, 202, 204 | 251, 252 |
| 251 | Burner body (front) | 201 | 202 | 251 |
| 251F | Fount (Two Quart) | | | 251 |
| 251K | Burner body (front) | 203 | 204 | 253 |
| 252F | Fount (Two Quart) | | | 252 |
| 255 | Preheater cup | 201, 203 | 202, 204 | 251, 252 |
| 257 | Filler plug | | 202, 204 | 251, 252 |
| 259 | Burner body (back) | 201 | 202 | 251 |
| 259K | Burner body (back) | 203 | 204 | 253 |
| 269 | Valve stem pack nut | 201, 203 | 202, 204 | 251, 252 |
| 281 | Windshield | 201, 203 | 202, 204 | 251, 252 |
| 284 | Valve stem packing | 201, 203 | 202, 204 | 251, 252 |
| 312 | Valve stem complete | 151 | 152 | |
| 851 | Burner body (one piece) | 91, 101 | 92, 102 | |
| 411 | Burner complete | 151 | 152 | |
| 451 | Burner body (one piece) | 151 | 152 | |
| 455 | Preheater cup | 91, 101, 151 | 92, 102, 152 | |
| 481 | Windshield | 151 | 152 | |
| *962DX | Gas tip wrench | All Models | All Models | 251, 252 |
| 1610A | Pump handle | " " | " " | " " |
| 1612 | Valve stem (cast iron wheel) | 91, 101 | 92, 102 | |
| 1613 | Pump rod | All Models | All Models | 251, 252 |
| 1617 | Needle bushing | 151, 201, 203 | 152, 202, 204 | " " |
| 1809 | Pump piston complete | All Models | All Models | " " |
| 1810 | Pump bushing lead washer | " " | " " | " " |
| 1811 | Pump piston | " " | " " | " " |
| 1812 | Pump leather | " " | " " | " " |
| 1813 | Pump piston nut | " " | " " | " " |
| 1814 | Pump rod nut | " " | " " | " " |
| 1815 | Pump rod cushion spring | " " | " " | " " |
| 1816 | Pump check valve cork | " " | " " | " " |
| 1817 | Pump check valve spring | " " | " " | " " |
| 1819 | Lead washer for filler plug | 101, 151, 201, 203 | 102, 152, 202 | " " |
| 2612 | Valve stem (bakelite wheel) | 151, 201, 203 | 152, 202, 204 | " " |
| 2618 | Vaporizer tube | 201, 203 | 202, 204 | " " |
| 2618K | Vaporizer filler | 203 | 204 | 253 |
| 2621 | Pump cap | All Models | 102, 152, 202, 204 | 251, 252 |
| 2819 | Lead washer for filler plug | | 202, 204 | " " |

* Packed and sold separately.

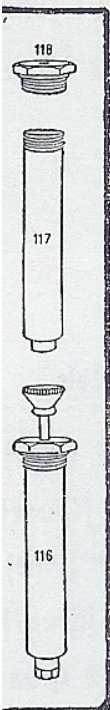

RCH